

ShipConstructor Shows & Seminars in Singapore & Japan

In March 2004, *ShipConstructor* teams from ARL & Autodesk-Asia were at the joint booth 3D-18 at the three days trade show of Asia Pacific Maritime (www.apmaritime.com). ARL specialists conducted a seminar on Thursday 25 March 2004, titled: “*Application of database driven CAD/CAM/CIM in large offshore structures*”. The seminar focused on how modern CAD/CAM systems with powerful databases, such as the *ShipConstructor2002* system used for a deep water spar oil rig, managed to link engineering designs and construction processes to corporate Enterprise Resource Planning (ERP) systems. The very large spar oil rig constructed by J. Ray McDermott Far East at Batam was launched into the sea in the Mexican Gulf in the Dominion Devils Tower field in 2003. The huge project is the first time a complex spar is constructed in the Far East using modern CAD/CAM/CIM techniques and ARL is proud to have been a pioneer in the field. The Asia Pacific Maritime trade show attracted many international visitors from Asia including professionals from India and the Middle East marine industries. We are pleased to announce ARL has signed up a key reseller to serve customers covering a region from India to the Middle East and Africa.(see below)

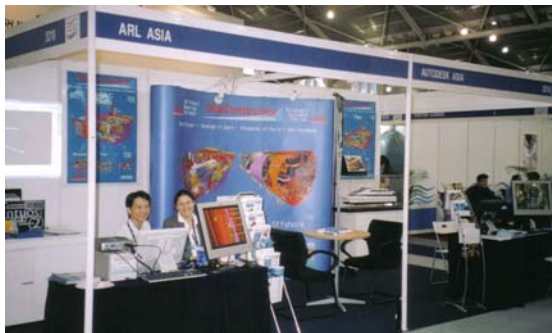

ARL and Autodesk Asia joint booth; a strategic business partnership to better serve marine customers!

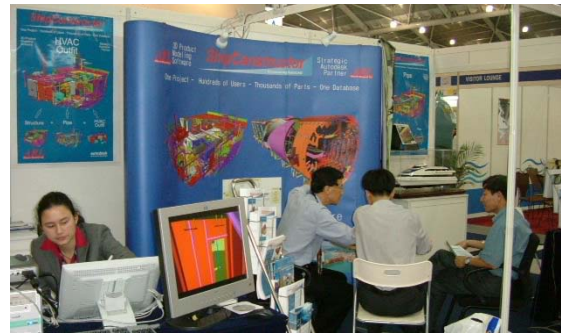

SNAMES seminar on database driven CAD/CAM/CIT and post-seminar discussions with client

New releases from ShipConstructor for a perfect match with AutoCAD 2004 & 2005 platform

ShipConstructor2004, released in DEC 2003, is a more powerful suite of software fully compatible with and taking advantage of new features in AutoCAD2004. The *ShipConstructor2004* has modules for job functions including management, fairing, lofting, detailing, piping, HVAC, nesting, outfitting, CNC, etc and a full SQL parts database. Being a young and dynamic company, ARL make use of modern software development platforms and techniques to leverage on new technology. Unlike companies with software based on older technology, ARL is able to release new software builds more regularly to respond to new requirements from customers. Before June 2004, ARL will also release *ShipConstructor2005* to take advantage of new features in AutoCAD2005 which has just been released the same week as the Asia Pacific Maritime show. If you are interested in latest shows and software download from *ShipConstructor*, please use our website:-

http://www.shipconstructor.com/sc_downloads.html & http://www.shipconstructor.com/news_tradeshows.html

SEAJAPAN trade show and seminar with our strategic business partner

ShipConstructor teams from ARL & Autodesk-Asia will be at the three days trade show of SEAJAPAN (www.seajapan.com) at the Tokyo Bigsight exhibition center April 14-16, 2004. On April 14, ARL president Rolf G. Oetter will present a paper titled "ShipConstructor - Modernizing the Shipbuilding Process the Efficient Way" at the New Technology Seminar. Our team at the exhibition and seminar will showcase ShipConstructor2004 and also introduce new features in the yet-to-released ShipConstructor2005 modules for enhancement in job functions including management, fairing, lofting, detailing, piping, HVAC, nesting, outfitting, CNC, etc and a full SQL parts database.

About Albacore Research Ltd. and ShipConstructor

ARL has grown steadily since it pioneered PC-based shipbuilding software development in 1990. ShipConstructor is the most popular and innovative software suite created by ARL to assist builders to create a detailed product model at a fraction of conventional cost. Over 100 shipyards and naval architects worldwide use ShipConstructor to produce vessel from 20m tugs to 200m rig weighing 12,900 tons. ARL software is designed to run in MS-Windows, integrated with AutoCAD to ensure user-friendliness and easy training and ShipConstructor is supported by MS-SQL database.

About ARL Asia Pte Ltd

ARL Asia has been set up to provide better CAD/CAM system integrator in Asia Pacific region for all ShipConstructor clients and also co-ordinate sales and technical support with Autodesk Inc. in Asia.

About Peripheral Solutions (S) Pte Ltd

PSL has been an IT equipment and software distributor involve in CAD/CAM integration in Asia Pacific since 1986. Many regional shipyards have ShipConstructor supported by PSL since 1995.

About Aries Marine & Engg Services (www.ariesmarine.co.ae)

ARIES is our new ShipConstructor business partner with extensive marine industries design, survey and consultancy services experience and will provide ShipConstructor sales and support services covering a wide geographical region of Africa, India, and the Middle East.

Stop Press – Strategic Business Alliance with Formation Design Systems

Following a very successful series of meetings including a ShipConstructor Seminar in Fremantle, Australia, on February 12, 2004, ARL and Formation Design Systems (FDS) officially announced the strategic business alliance between the two companies. FDS and ARL have enjoyed a successful business alliance since 2003, when the two companies initiated the integration between ARL's ShipConstructor and FDS' Maxsurf suite of naval and ship construction software with the objective to provide a complete end-to-end solution for ship design, detailing, and production to naval architects, designers, and shipyards. FDS will sell and support the ShipConstructor product range as ARL's dealer for Australia, New Zealand and South East Asia, and through the FDS dealer network world-wide. ARL Asia is the reseller for all FDS product including Maxsurf, Hydromax, Hullspeed, Multiframe, Workshop, etc. Refer : http://www.albacoreresearch.com/pdf_publications/2004-04-01ARL-FDS_PressRelease.pdf

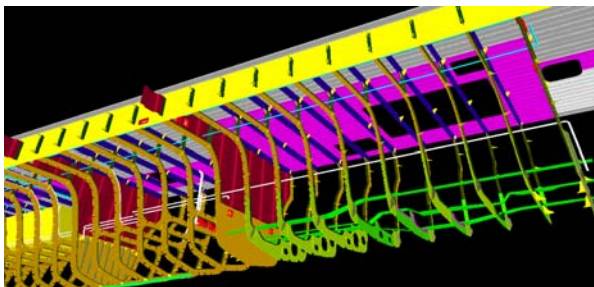

Successful projects at Damen shipyards with the integration of Maxsurf and ShipConstructor paved the way for a strong business alliance between software developers ARL and Formation Design Systems (FDS)